

**Forged Steel – Gate, Globe & Check Valves
ASME Class 800**

Sizes DN 15 to 50, NPS 1/2 to 2

**A Range of Class 800 Reduced Bore Forged Steel Valves with Screwed,
Socket-Weld, Butt-Weld & Flanged Ends.**

FROM

REVOLVE VALVES

Manufacturers of Industrial Valves

REVOLVE VALVES reserve the right to change product design and specification.

GATE VALVES



Standard Features

- Forged Body and Bonnet
- Integral Bonnet and Yoke
- Graphite Filled Stainless Steel Gasket
- Self Aligning Gland/Gland Flange
- High Tensile Bolts
- Ductile Iron Hand Wheel
- Adequate Graphite Gland Packing
- Precision Machined Integral backseat
- Blackodized Body/Bonnet to prevent Rusting
- Tested according to API 598

PARTS LIST

No.	Description	Material		
		A105/Trim1	A105/Trim5	A105/Trim8
1	Body	A105	A105	A105
2	Seat Ring	410	410 + STL	410 + STL
3	Wedg	410	410 + STL	410
4	Gasket	SS 304 + Graphite	SS 304 + Graphite	SS 304 + Graphite
5	Bonnet	A105	A105	A105
6	Spindle	410	410	410
7	Bolt	High Tensile	High Tensile	High Tensile
8	Gland Packing	Graphite	Graphite	Graphite
9	Screw Pin	MS Galvanized	MS Galvanized	MS Galvanized
10	Washer	MS Galvanized	MS Galvanized	MS Galvanized
11	Gland Bush	410	410	410
12	Gland Flange	A105	A105	A105
13	Eyebolt Nut	Forged Carbon	Forged Carbon Steel	Forged Carbon Steel
14	Eyebolt	Forged Carbon	Forged Carbon Steel	Forged Carbon Steel
15	Spindle Bush	Carbon Steel	Carbon Steel	Carbon Steel
16	Handwheel	Ductile Iron	Ductile Iron	Ductile Iron
17	Locknut	Carbon Steel	Carbon Steel	Carbon Steel

Forged Steel – Gate, Globe & Check Valves
ASME Class 800

Sizes DN 15 to 50, NPS 1/2 to 2

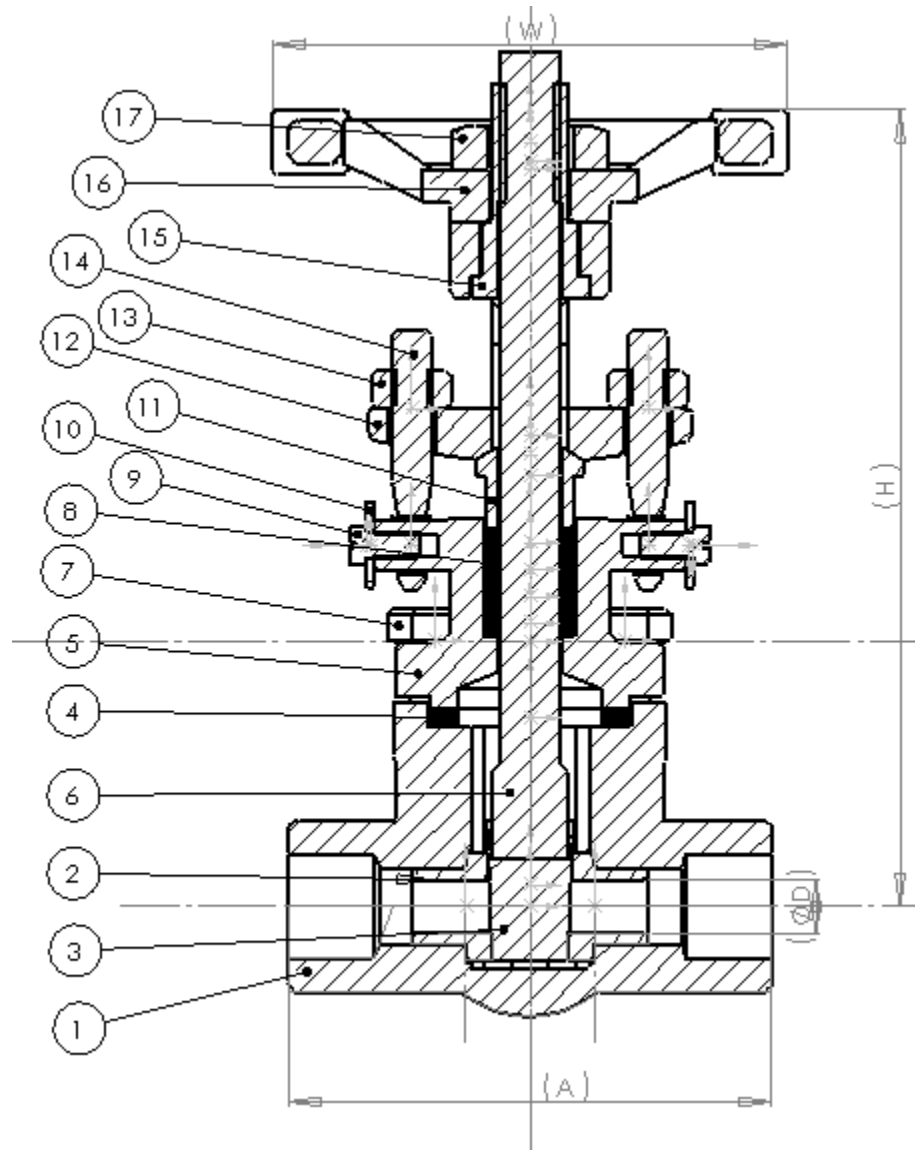

DIMENSIONS

Valve Size		øD	A	H	W
DN	NPS				
15	1/2	10	90	150	95
20	3/4	13	93	155	95
25	1	19	108	165	95
40	1 1/2	32	125	195	140
50	2	38	140	240	140

REVOLVE VALVES reserve the right to change product design and specification.

GLOBE VALVES

Standard Features



- Forged Body and Bonnet
- Integral Bonnet and Yoke
- Graphite Filled Stainless Steel Gasket
- Self Aligning Gland/Gland Flange
- High Tensile Bolts
- Ductile Iron Hand Wheel
- Adequate Graphite Gland Packing
- Precision Machined Integral backseat
- Blackodized Body/Bonnet to prevent Rusting
- Tested according to API 598

PARTS LIST

No.	Description	Material		
		A105/Trim1	A105/Trim5	A105/Trim8
1	Body	A105	A105	A105
2	Seat	410	410 + STL	410 + STL
3	Plug	410	410 + STL	410
4	Gasket	SS 304 + Graphite	SS 304 + Graphite	SS 304 + Graphite
5	Bonnet	A105	A105	A105
6	Spindle	410	410	410
7	Bolt	High Tensile	High Tensile	High Tensile
8	Gland Packing	Graphite	Graphite	Graphite
9	Screw Pin	MS Galvanized	MS Galvanized	MS Galvanized
10	Washer	MS Galvanized	MS Galvanized	MS Galvanized
11	Gland Bush	410	410	410
12	Gland Flange	A105	A105	A105
13	Eyebolt Nut	Forged Carbon	Forged Carbon Steel	Forged Carbon Steel
14	Eyebolt	Forged Carbon	Forged Carbon Steel	Forged Carbon Steel
15	Spindle Bush	Carbon Steel	Carbon Steel	Carbon Steel
16	Handwheel	Ductile Iron	Ductile Iron	Ductile Iron
17	Handwheel Washer	Carbon Steel	Carbon Steel	Carbon Steel
18	Locknut	Carbon Steel	Carbon Steel	Carbon Steel

Forged Steel – Gate, Globe & Check Valves
ASME Class 800

Sizes DN 15 to 50, NPS 1/2 to 2

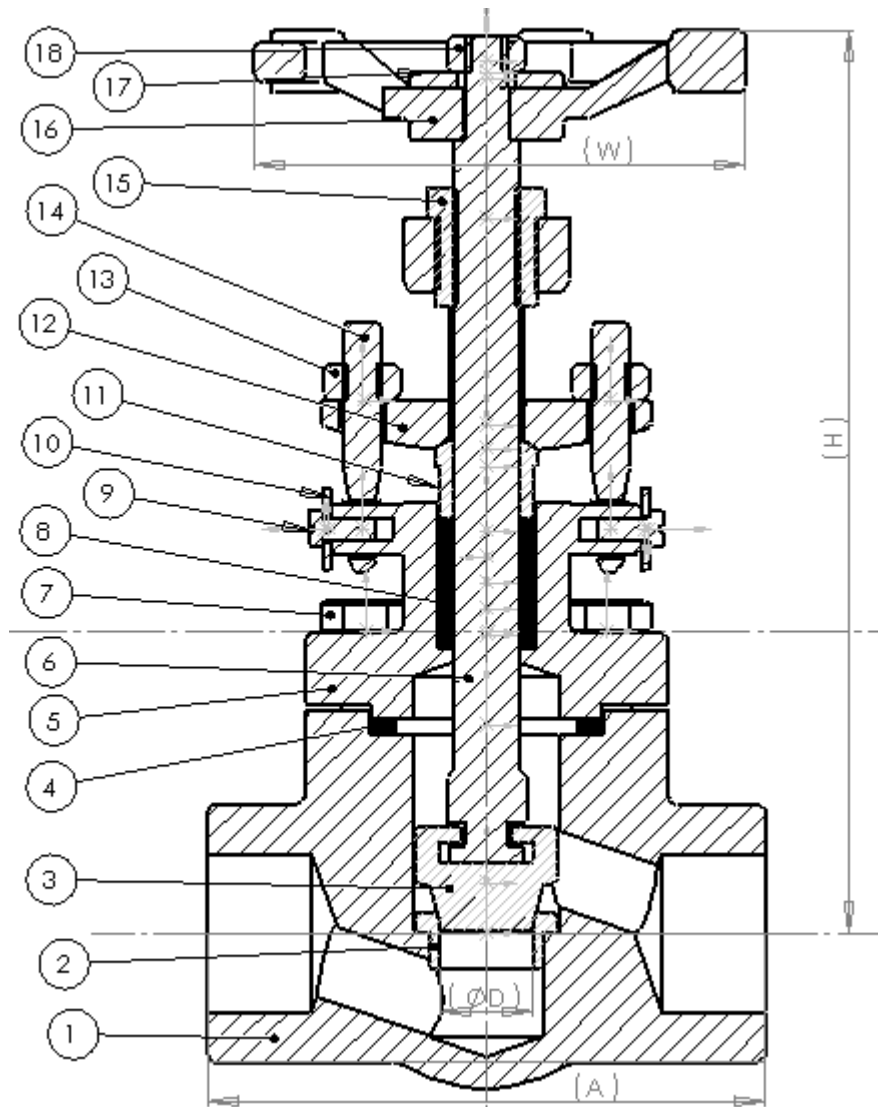

DIMENSIONS

Valve Size		øD	A	H	W
DN	NPS				
15	1/2	9	90	163	95
20	3/4	12	93	163	95
25	1	18	108	175	95
40	1 1/2	30	125	210	140
50	2	36	140	260	140

REVOLVE VALVES reserve the right to change product design and specification.

Forged Steel – Gate, Globe & Check Valves
ASME Class 800

Sizes DN 15 to 50, NPS 1/2 to 2

CHECK VALVES



Standard Features

- Forged Body and Cover
- Graphite Filled Stainless Steel Gasket
- High Tensile Bolts
- Stainless Steel Spring for High Performance
- Blackodized Body/Bonnet to avoid Rusting
- Tested according to API 598

REVOLVE VALVES reserve the right to change product design and specification.

**Forged Steel – Gate, Globe & Check Valves
ASME Class 800**

Sizes DN 15 to 50, NPS 1/2 to 2

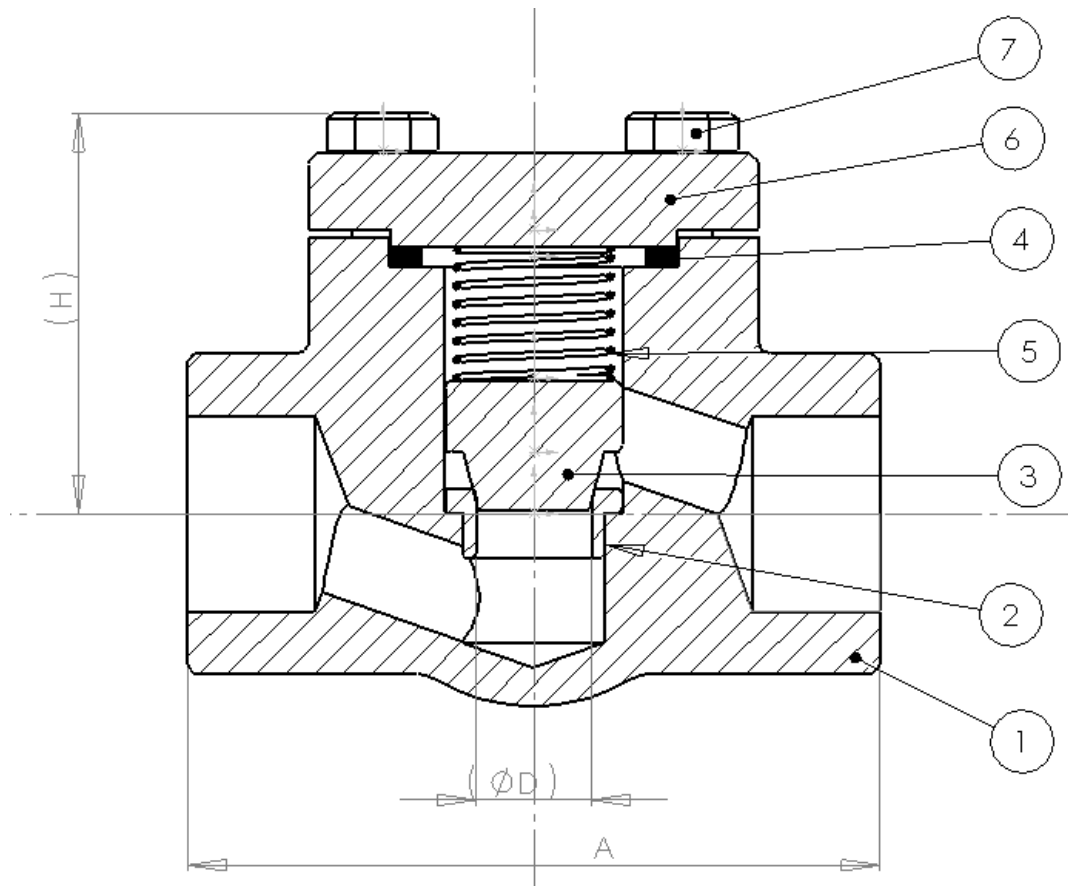

PARTS LIST

No.	Description	Materials		
		A105/Trim1	A105/Trim5	A105/Trim8
1	Body	A105	A105	A105
2	Seat	F6a	F6a + STL	F6a +STL
3	Plug	F6a	F6a + STL	F6a
4	Gasket	SS 304 + Graphite	SS 304 + Graphite	SS 304 + Graphite
5	Spring	Stainless Steel	Stainless Steel	Stainless Steel
6	Cover	A105	A105	A105
7	Bolt	High Tensile	High Tensile	High Tensile

DIMENSIONS

Valve Size		øD	A	H
DN	NPS			
15	1/2	9	90	56
20	3/4	12	93	58
25	1	18	108	63
40	1 1/2	30	125	100
50	2	36	140	120

REVOLVE VALVES reserve the right to change product design and specification.

**Forged Steel – Gate, Globe & Check Valves
ASME Class 800**

Sizes DN 15 to 50, NPS 1/2 to 2

For inquiries, kindly contact:

Regd. Office:

REVOLVE VALVES & BEARINGS

Ashrafi Manzil, 3 Baker Lane,
Dockyard Road Station (E),
Mazagaon, Mumbai- 400010 (MH State)
Tel: 022- 23776862
E-mail: revolvevalves@gmail.com

Works:

REVOLVE VALVES / REVOLVE CONTROLS

An ISO 9001: 2008 Certified Co.

C/4, Archana Estate (Part II),
Near Rakhiyal Post Office,
Rakhiyal, Ahmedabad- 380023 (Gujarat State)